

## Low Profile Portion Control Grinder with 2 Hoppers

ITEM#

PROJECT

DATE



### Model LPG2E

*(funnel sold separately)*

Dimensions: 17.5"H x 8.6"W x 11"D  
(44.5cm H x 21.84cm W x 27.94cm D)

### Features

#### Portion Control Grinder

- Just 8.6" (21.84 cm) wide and a low profile.
- Professional grind provided by large 3.19" (8.1 cm) diameter burrs powered by quiet, low speed, high torque motor.
- Two hoppers allow for regular and decaf or specialty beans.
- Large, clear bean hoppers merchandise 3 lbs. (1.36 lbs.) each of fresh coffee beans.
- Easy access on back for grind weight adjustment.
- Three year warranty on grinding burrs.

For current specification sheets and other information, go to [www.bunn.com](http://www.bunn.com).

### Related Products

#### Precision Burrs

All BUNN grinders use precision burrs to cut (not crush) the coffee beans and deliver consistent grind distribution. BUNN burrs are rated at a Rockwell hardness of 66C, resulting in an exceptionally long burr life.



#### Standard Grind Burr Set

Product No: 05861.1002

#### Fine Grind Burr Set

Product No: 11285.1000

#### Fine Grind Dechaffer Kit

Product No: 43724.0000

#### Standard Dechaffer (2 required)

Product No: 20588.0000

Model

LPG2E

Agency Listing



## Dimensions & Specifications

Model	Product #	Volts	Amps	Capacity	Cu. Ft.	Shipping Weight	Cord Attached
LPG2E	26800.0000	120	3.5	3 lbs. for each hopper	2.6 ft <sup>3</sup>	28 lbs.	Yes**
LPG2E*	26800.0001	120	3.5	3 lbs. for each hopper	2.6 ft <sup>3</sup>	30 lbs.	Yes**

\*Model has 4" stainless steel legs. \*\*Power cord (NEMA 5-15P) 15 Amp-120V machine only.

Electrical: Model requires 2-wires plus ground service rated 120V, single phase, 60 Hz.

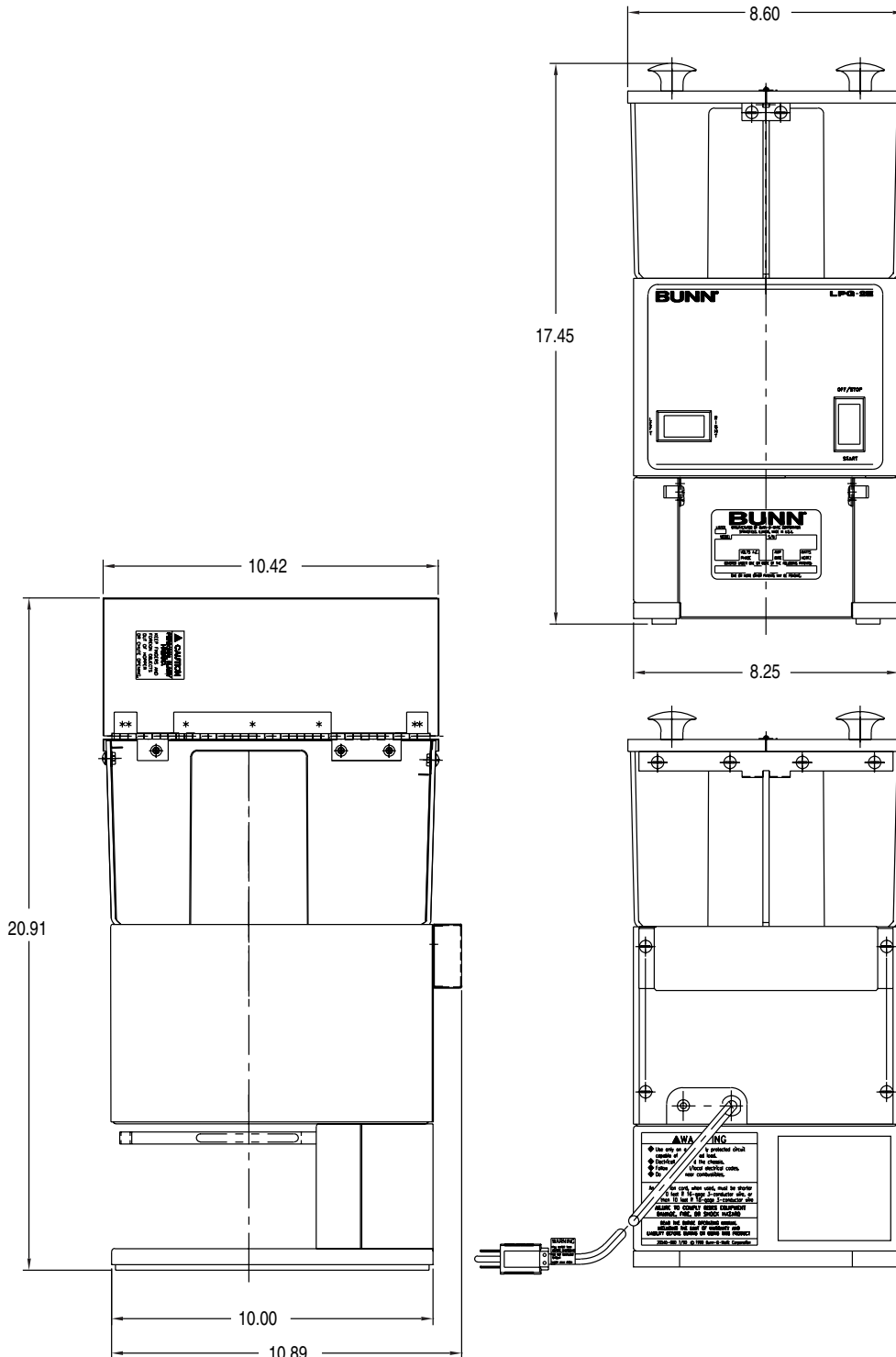

Bunn-O-Matic® Corporation - 1400 Stevenson Drive Springfield, Illinois 62703 • 800-637-8606 • 217-529-6601 • Fax 217-529-6644 • www.bunn.com

BUNN® practices continuous product research and improvement. We reserve the right to change specifications and product design without notice. Such revisions do not entitle the buyer to corresponding changes, improvements, additions or replacements for previously purchased equipment.

All dimensions shown in inches.